

DFK cores

DFK80X20X20A

CORE SETS (4Pcs)

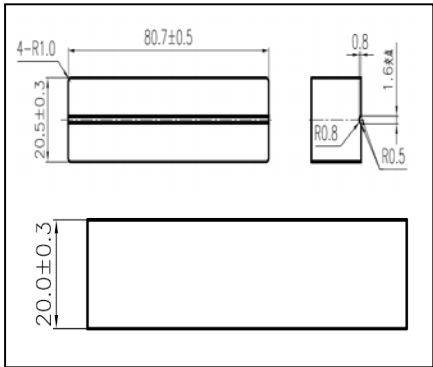

SYMBOL	PARAMETER	VALUE	UNIT
$\Sigma(I/A)$	core factor(C_1)	7.46	cm^{-1}
V_e	effective volume	125.46	cm^3
l_e	effective length	30.6	cm
A_e	effective area	4.1	cm^2

Characteristic

AL(nH/N2)	Part No.	Percent initial Permeability ($\% \mu_0$)		Core Loss (mW/cm^3)	
		50 Oe	100 Oe	50kHz/100mT	100kHz/100mT
4Pcs 组合	FeSiAl				
39	DS270026	90	79	300	900
91	DS270060	71	45	250	700
114	DS270075	60	35	230	650
136.5	DS270090	55	27	200	550
190	DS270125	40	18	200	550

AL(nH/N2)	Part No.	Percent initial Permeability ($\% \mu_0$)		Core Loss (mW/cm^3)	
		50 Oe	100 Oe	50kHz/100mT	100kHz/100mT
4Pcs 组合	FeSi				
39	DF270026	88	78	1500	3300
91	DF270060	73	55	800	2700
114	DF270075	66	47	800	2600
136.5	DF270090	57	35	800	2500

AL(nH/N2)	Part No.	Percent initial Permeability ($\% \mu_0$)		Core Loss (mW/cm^3)	
		50 Oe	100 Oe	50kHz/100mT	100kHz/100mT
4Pcs 组合	FeSiNi				
39	DFF270026	92	85	550	1500
91	DFF270060	90	74	500	1200
114	DFF270075	78	55	500	1200
136.5	DFF270090	75	45	500	1200

备注：DC Bias与Core Loss为压制标准环D*270所测得典型值，实际产品的测试数据会有所波动。